



# THE FAR NORTH

*ABOARD LE COMMANDANT CHARCOT*

A SELECTION OF WINTER CRUISES 2024-2025





## The Far North as you've never seen it before



As *Le Commandant Charcot* was designed for you to experience unforgettable moments, this winter collection promises something very special. After a summer spent in the Arctic, our exploration ship stays in the Far North to reveal all the magic and majesty of the white season with these new itineraries.

Awaiting you are the vibrant colours of polar nights lit up by the Northern Lights, the heady scent of spices in Scandinavia's Christmas markets and the emotions aroused when sailing on an ice-encrusted St Lawrence River, aboard the only ship able to operate at this time of year.

This is your opportunity to bid farewell to the sun against the backdrop of fjords or the Spitsbergen mountains, as they gradually acquire their winter finery, before heading to north Norway for a voyage beyond the Arctic Circle. You will be charting a course along the west coast taking in the Lofoten Islands, majestic fjords and charmingly emblematic towns. You will be sailing between Baltic cities aglow with a festive ambiance in the run up to a magical Christmas, an experience enriched by the presence on board of the multi-Michelin star chef, Alain Ducasse. Finally, you can start 2025 with an exclusive voyage of discovery to Quebec in the snow, where pristine forests and an icy river will give you a host of opportunities to enjoy all the activities of a Canadian winter.

The ambiance on board is one of elegance and comfort where staterooms, suites and communal areas, together with personalised service and superb gourmet food, offer a truly unique travel experience and explorations that will leave you with lasting memories.

See you soon on board,

*Hervé Gastinel*  
CEO, PONANT

# 10 EXPERIENCES

only *Le Commandant Charcot*  
can offer you in the Far North





# 1

## REACHING THE INACCESSIBLE

Embarking on a voyage to the Far North in winter is about enjoying the Northern Lights, the end of year Nordic festivities and exploring the icy St Lawrence River. Indeed, the only passenger ship of this level that can venture on to it is *Le Commandant Charcot*.



# 2

## ICE NAVIGATION: A CHALLENGE WITHOUT EQUAL

It is the only passenger vessel in the world to have a Polar 2 (PC2) class hull which means the ship can sail through multi-year ice all year long.

# 3

## THE BEST EXPERTS

Accompanying you on your journey, around 20 naturalists guides are on hand to unravel polar history, reliefs, wildlife and flora. As for the officers, they are very experienced at navigating in the ice.

# 4

## TOTAL IMMERSION ON THE ICE SHEET

Dog sledding, snowshoeing, ice fishing, snow biking, kayaking in icy waters and meeting local communities await you. Experience a deep connection with the power of nature in the Far North.

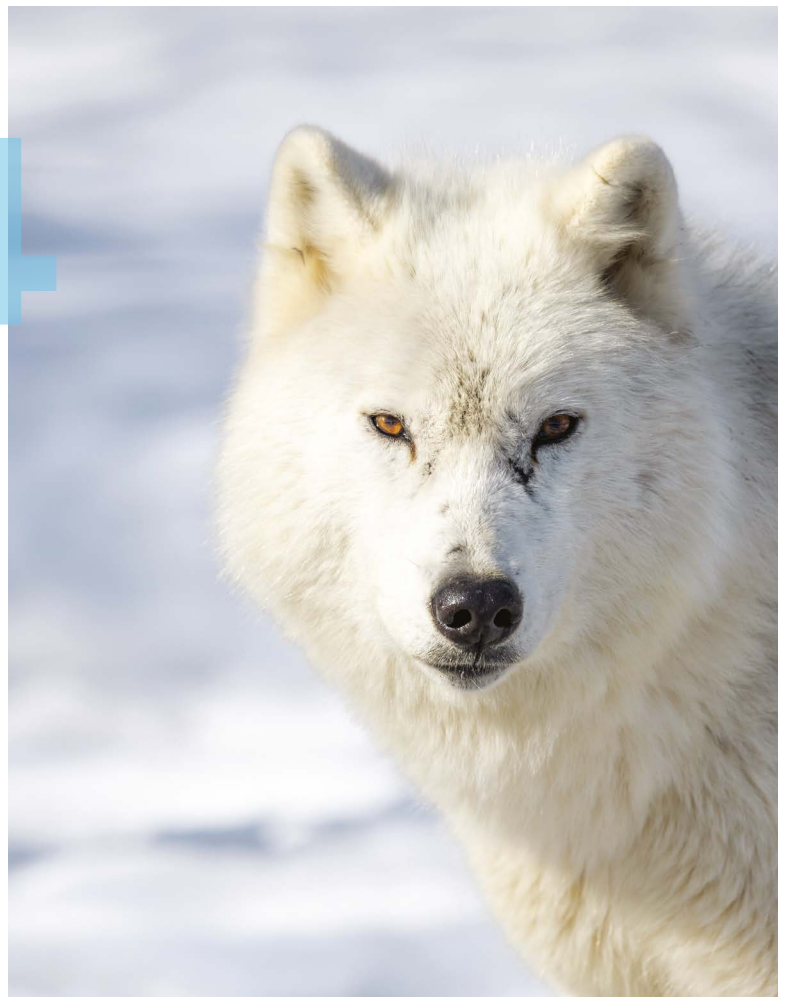

# 5

## INSIDE-OUTSIDE: THE INVISIBLE FRONTIER

On board, staterooms and communal areas offer a cosy cocoon which is wide open to the grandiose décor and extreme environments that surround you.



# 6

## THE ONLY ALAIN DUCASSE RESTAURANT AT SEA

The *Nuna* (Earth in Inuit) offers a gastronomic menu created by this Michelin star chef, as well as some of his signature dishes.



# 7

## SAILING FOR SCIENCE

*Le Commandant Charcot* has two laboratories equipped with state-of-the-art facilities and hosts researchers from renowned institutes on every voyage.



# 8

## A MORE ECO-FRIENDLY HYBRID ENGINE

A combined electric/liquefied natural gas engine enables *Le Commandant Charcot* to reduce its emissions: -25% CO<sub>2</sub>, -85% nitrogen oxides and -95 % fine particles.

# 9

## YOUR DEDICATED CONCIERGE SERVICE

A team of experts is at your service to help you prepare your voyage down to the smallest detail, with tailor-made services.

Your dedicated contact:  
[conciergerievoyage@ponant.com](mailto:conciergerievoyage@ponant.com)

## UP TO €1,500 FREE FLIGHT CREDIT

Set sail with a light heart! Book your flights and hotel nights before and after your voyage through PONANT and benefit from **€800 to €1,500 credit** per guest<sup>(1)</sup>.

Depending on the departures, charter flights and transfers may also be included in the price of your cruise to give you total peace of mind as you set sail for the northernmost latitudes.

Be it solo travellers, family and friends, or members of the PONANT Yacht Club loyalty programme... details of all your PONANT offers are at:  
[en.ponant.com/ponant-benefits](https://en.ponant.com/ponant-benefits)

# 10

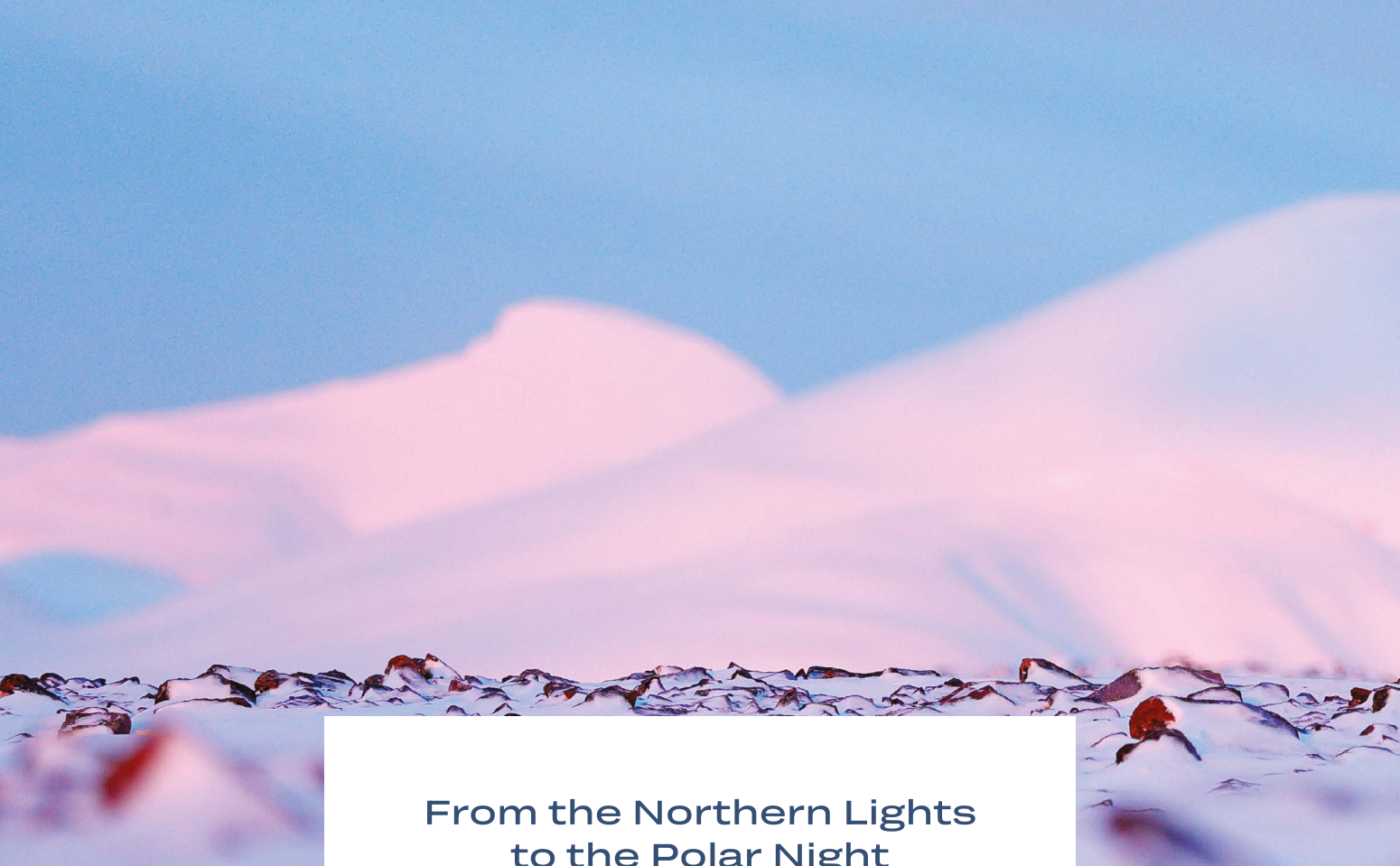

## From the Northern Lights to the Polar Night

### TROMSØ · LAKSELV

12 days / 11 nights on board *Le Commandant Charcot*

Departure: 18<sup>th</sup> October 2024

From €12 820 <sup>(2)</sup>

Experience the unique timeless nature of life beyond the Arctic Circle! Close to the legendary North Cape, Lapland is revealed in all its glory through exceptional panoramas, Northern Lights and meetings with one of Europe's last surviving indigenous people, the Sami. A magical winter exploration of untamed nature awaits.







**HIGHLIGHTS:**

- An unprecedented voyage beyond the Arctic Circle.
- A unique experience in total communion with the surrounding scenery and local people.
- An opportunity to reach the legendary North Cape, the northernmost point of Europe.
- The prospect of seeing the enchanting spectacle of the Northern Lights.
- Bid farewell to the sun in the fjords of Spitsbergen before the long polar night.
- Winter activities (to be pre-booked before departure): kayaking, encounters and discovering Sámi culture and communities, visiting a fishing village, chasing the Northern Lights, and more.
- Expert support from a reinforced team of nature guides throughout the cruise.
- Workshops and talks with one of our renowned Photo Ambassadors to help you get all the best shots.

*The itinerary, landings, wildlife observations, activities and highlights cannot be guaranteed and are subject to weather conditions.*

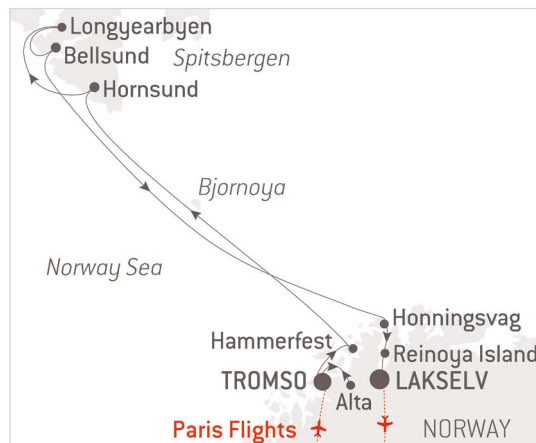

**Included in your cruise <sup>(3)</sup>:**  
 flights Paris/Tromsø  
 and Lakselv/Paris as well as transfers.





## Autumn splendours from Lofoten to the Norwegian Fjords

**NARVIK · BERGEN**

14 days / 13 nights onboard *Le Commandant Charcot*

Departure: 7<sup>th</sup> November 2024

**From €12 010 <sup>(2)</sup>**

€300 FLIGHT CREDIT OFFERED <sup>(1)</sup>

Between *sker* (rocky islets in Old Norse) and the sea along the shores of Norway enjoy the seasonal chiaroscuro contrasts. Relish the feeling of being lost in the Lofoten Islands and immerse yourself in nature and stunning fjords surrounded by snow-capped peaks. As it was in the past for the Vikings, being so close to the elements between coastal towns and fishing villages is a way of life.





### HIGHLIGHTS:

- For the first time in winter with PONANT, discover Norway's treasures between the Lofoten archipelago, fjords and fabulous cities.
- Discover wild nature and the Viking heritage of the Lofoten archipelago.
- An opportunity to see the Northern Lights.
- The Geirangerfjord UNESCO World Heritage Site and Songerfjord, the world's second largest fjord.
- Discover emblematic Scandinavian architecture: Bryggen, Bergen's Hanseatic district (a UNESCO World Heritage Site), Ålesund's Art Nouveau district and the rorbuer, dark red fishing huts.
- Winter activities (to be pre-booked before departure): kayaking, the Lofoten Islands on horseback, ice fishing, chasing the Northern Lights, and more.
- Expert support from a reinforced team of nature guides throughout the cruise.
- Workshops and talks with one of our renowned Photo Ambassadors to help you get all the best shots.

*The itinerary, landings, wildlife observations, activities and highlights cannot be guaranteed and are subject to weather conditions.*



**Included in your cruise <sup>(3)</sup>:**  
outward flight Paris/Narvik, and transfer.





*Longyearbyen facing pristine landscapes in autumn.*



*Early winter morning in the Lofoten islands.*

*Bearded seal in the Hornsund fjord, south Spitsbergen.*





*Ready for Christmas in Riga city hall's square.*



*Festive dusk at the foot of Helsinki's cathedral.*

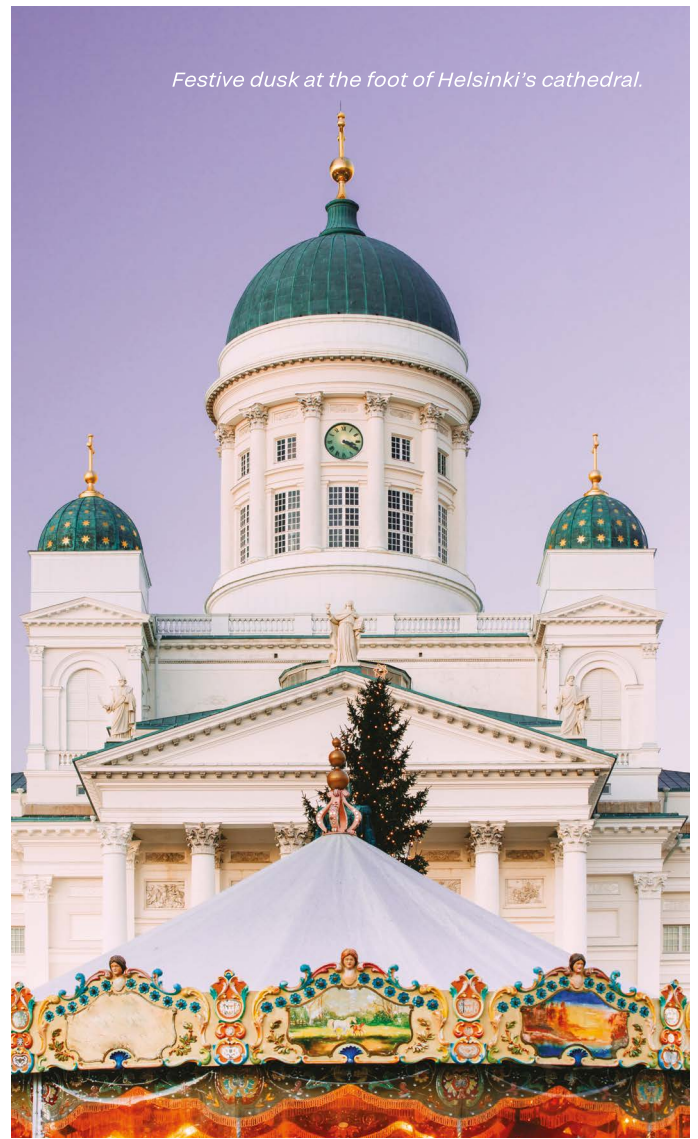

*Cosy warmth at Gamla Stan Christmas market, Stockholm.*



*Polar aurora on a northern winter night in Québec.*





*Impromptu encounter in Saguenay.*



*Snow biking in the icy Gulf of the St Lawrence River.*

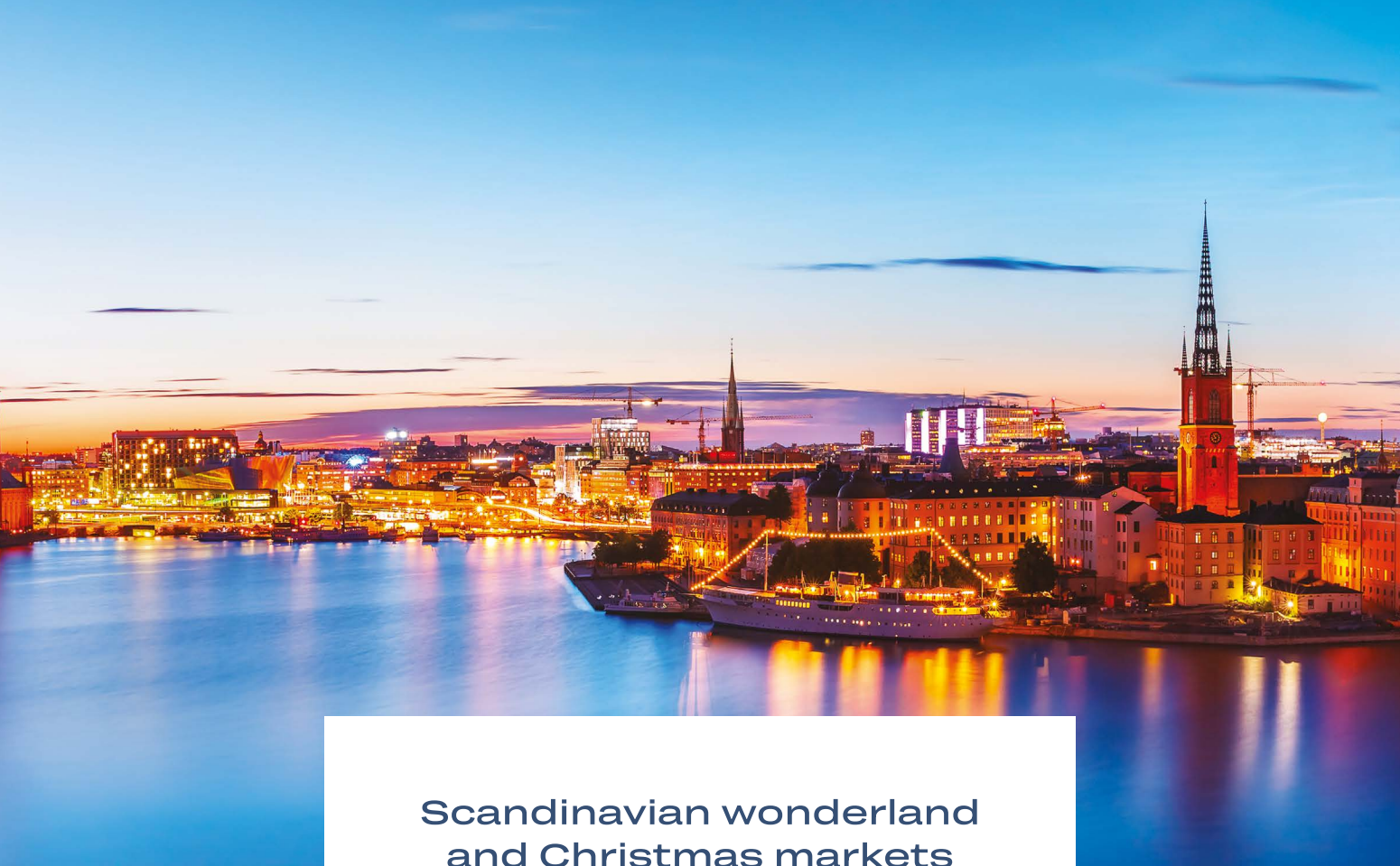

## Scandinavian wonderland and Christmas markets

**HELSINKI • HELSINKI**

10 days / 9 nights onboard *Le Commandant Charcot*

Departure: 2<sup>nd</sup> and 11<sup>th</sup> December 2024

**From €8 170 <sup>(2)</sup>**

**2<sup>ND</sup> DECEMBER DEPARTURE: €300 FLIGHT CREDIT OFFERED <sup>(1)</sup>**

As the Christmas holiday beckons the cold sets in for Baltic cities as the heady scent of gingerbread wafts through traditional Scandinavian markets. From the elegant comfort of your ship, admire natural scenes and stunning architecture slip by, bathed in wintery light.

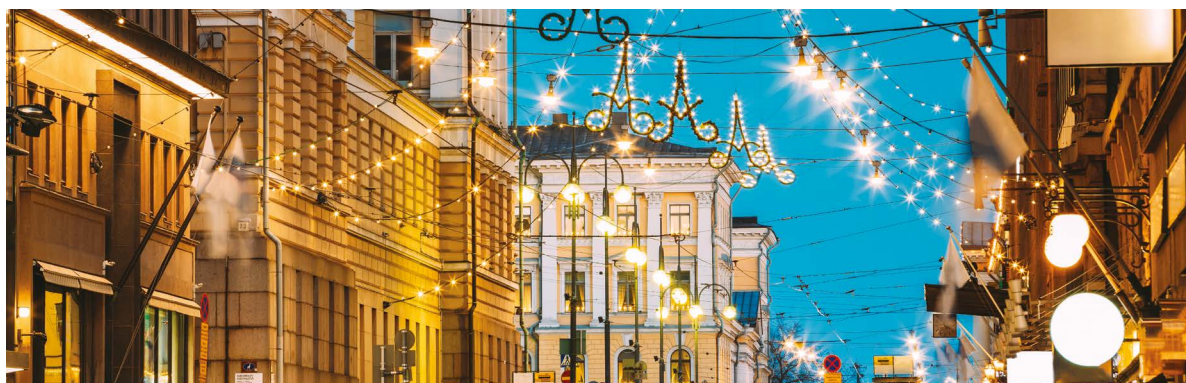



### HIGHLIGHTS:

- The Baltic Sea's emblematic cities in the heart of winter for the very first time with PONANT.
- With your family, experience Christmas preparations and the magic of Scandinavian customs and way of life in winter.
- Visit traditional Christmas markets and learn about local crafts and tempting specialities.
- Discover fascinating landscapes when cruising, including to the Stockholm archipelago.
- Enjoy the enchantment of Scandinavian cities outside high season as you wander through towns of a thousand festive lights.
- Spend a magical overnight stay opposite Stockholm's original town centre.

*The itinerary, landings, wildlife observations, activities and highlights cannot be guaranteed and are subject to weather conditions.*



#### CULTURE

2<sup>nd</sup> December departure: with guest Julien Gueslin, historian and an expert in the Baltic countries.

#### ART DE VIVRE



11<sup>st</sup> December departure: with Jacques Nebot, founder of Kaviari and a leading caviar specialist, and a Michelin-star chef.

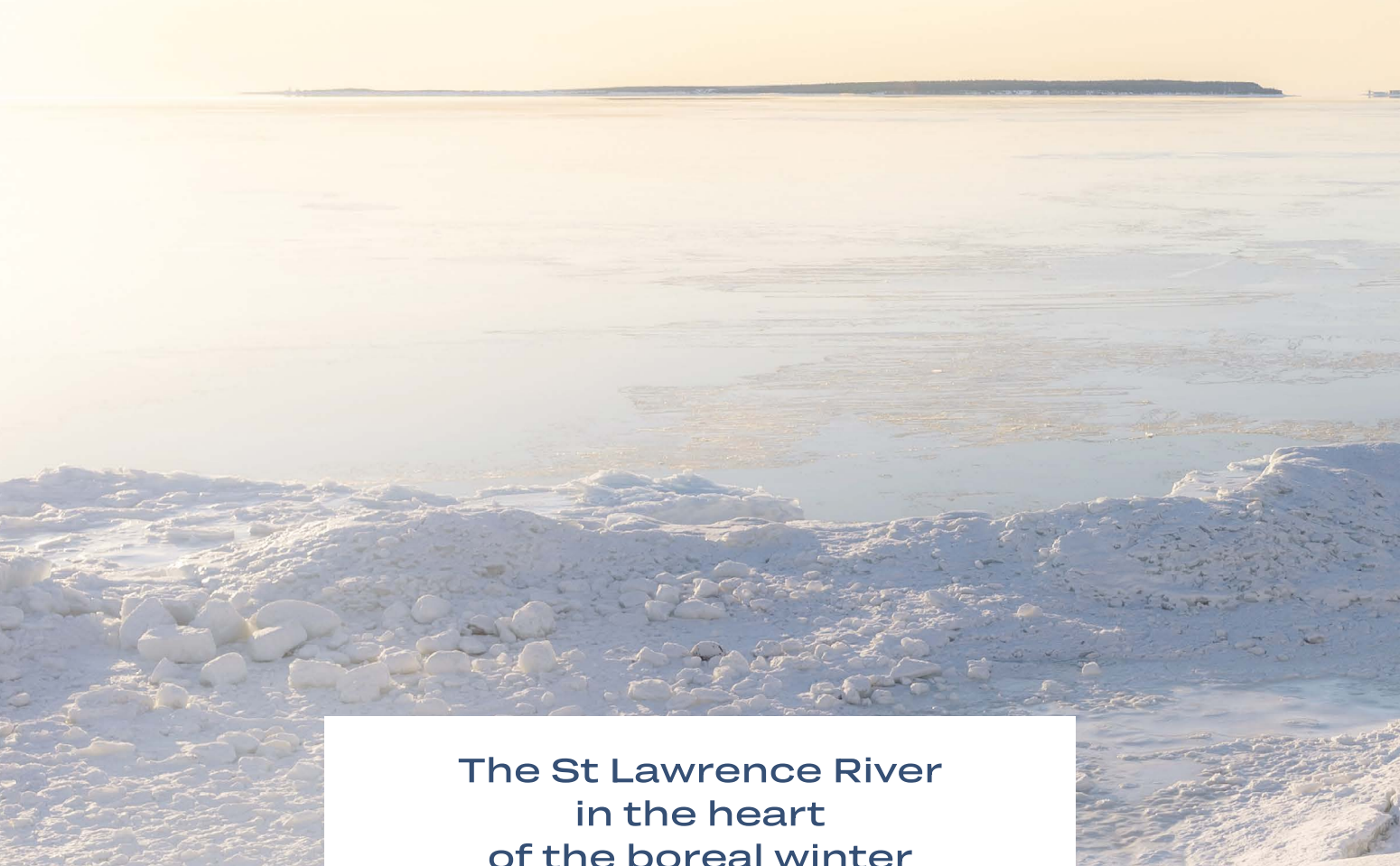

## The St Lawrence River in the heart of the boreal winter

### SAINT PIERRE AND MIQUELON • QUÉBEC

13 days / 12 nights on board *Le Commandant Charcot*

Departure: 17<sup>th</sup> January and 10<sup>th</sup> February 2025

Departure from Québec: 29<sup>th</sup> January and 22<sup>nd</sup> February 2025

**From €19 985 <sup>(2)</sup>**

€1 500 FLIGHT CREDIT OFFERED <sup>(1)</sup>

NO SINGLE SUPPLEMENT <sup>(4)</sup>

In the depths of the Canadian winter a truly exceptional voyage unfolds along the St Lawrence River where nature in all her glory is revealed. Unforgettable experiences await from the forests of conifers to snow-covered valleys and ice-encrusted seas, warmed by the welcome from the Québec and Innu communities.





Learn more about the scouting trip undertaken by our teams in Québec to put together this exclusive world-first voyage.



### HIGHLIGHTS:

- Explore the St Lawrence in winter, a PONANT exclusive: a journey only possible aboard *Le Commandant Charcot* that is capable of sailing through sea ice on the river at this time of year.
- Privileged encounters with Quebecers, the Innu and Micmac indigenous communities.
- An opportunity to witness the Northern Lights.
- Unforgettable overnight stays to take time contemplating the spectacle before you.
- A back drop of vast open spaces, fjords, immaculate boreal forests, sea ice and snow-covered valleys.
- Expert support from a reinforced team of nature guides throughout the cruise.
- Workshops and talks with one of our renowned Photo Ambassadors to help you get all the best shots.
- Winter activities such as kayaking, ice fishing and raw redfish tasting, dog sledding, fat biking, polar hiking on foot or snowshoes, local tasting sessions and meeting the Innu. Optional activities: polar climbing, ice canoeing, horse-drawn skiing.
- 10<sup>th</sup> and 22<sup>nd</sup> February 2025 departures: the chance to watch baby seals being born in the Magdalen Islands, the only place in the world where this can be observed.

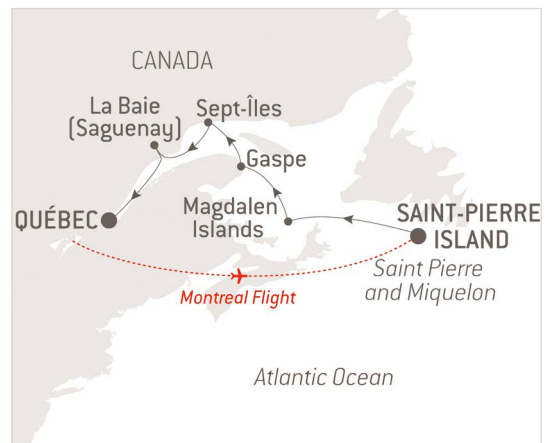

**Included in your cruise <sup>(3)</sup>:**  
the flight from Saint Pierre and Miquelon to Montreal or vice versa, and the transfer.

*The itinerary, landings, wildlife observations, activities and highlights cannot be guaranteed and are subject to weather conditions.*



# Le Commandant Charcot

*Le Commandant Charcot* was designed so you can experience odysseys of a lifetime to the Far North in an elegant setting.

The ship is a concentration of eco-responsible features, including an electric/liquefied natural gas engine never seen in a polar environment, to bear you away to unexplored territories safely, in communion with nature.

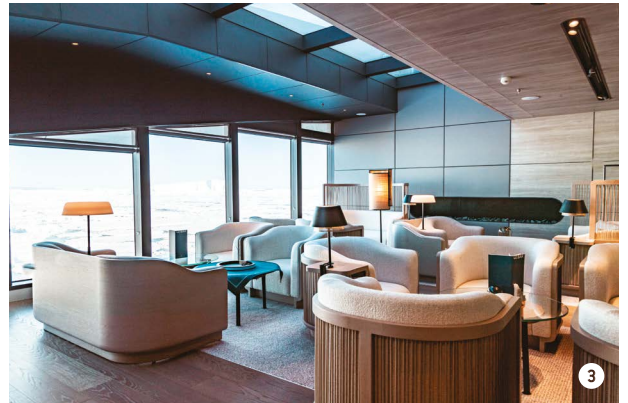

## IN DETAIL

Length: 150 m  
Width: 28 m  
Draft: 10 m - *twice as high as other vessels of this size*  
Average cruising speed: 15 knots  
Number of staterooms and suites: 123  
Crew members: 215  
Installed electrical power: 42 MW  
Year of delivery: 2021



**DRONE**

Take a tour of the ship.



5



6



7

- 1 - The sauna in the wellness area which includes the Biologique Recherche spa, hairdressing and manicure salon, fitness room and snow cabin.
- 2 - The wellness area with heated indoor pool, relaxation area and detox bar.
- 3 - The Observatory lounge and bar to the fore of Deck 9.
- 4 - *Nuna*, the only Alain Ducasse gastronomic restaurant at sea.

- 5 - *Le Commandant Charcot*.
- 6 - One of the Duplex Suites, Deck 6.
- 7 - The lounge in the Owner's Suite, Deck 8.

### Facilities and services for suites and staterooms

- Exclusive personalised services available to all guests through our Travel Concierge support
- Private balcony for all our staterooms and suites
- Terrace for Duplex Suites and Owner's Suite
- Butler and priority boarding: Owner's Suite, Duplex Suites, Privilège Suites, Grand Prestige Suites
- Individual air conditioning
- Double bed or two single beds depending on stateroom, possibility to have connecting staterooms for children
- Mini bar – Room service 24/24
- Flat screen TV, TV channels via satellite
- Video on demand
- Bose Bluetooth speaker
- Electronic safe
- Selection of Diptyque bath products
- Dressing room and hairdryer
- Direct satellite phone line
- 110 / 220 volt sockets
- Unlimited free internet WiFi access\*

*\*Depends on navigation region, WiFi may not be available for reasons beyond our control.*

# Deck plans

- Owner's Suite
- Duplex Suites
- Privilege Suites  
Deck 8
- Grand Prestige Suites  
Deck 6
- Prestige Suites  
Decks 7-8
- Deluxe Suites  
Decks 7-8
- Prestige Staterooms  
Decks 6-7-8

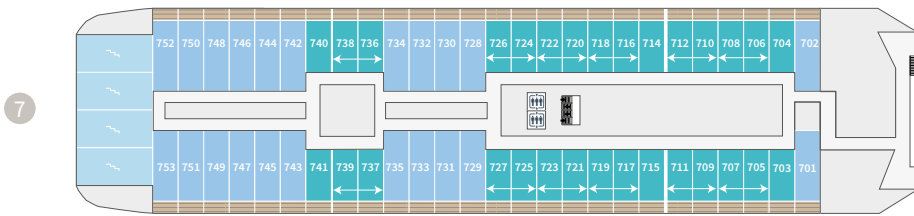
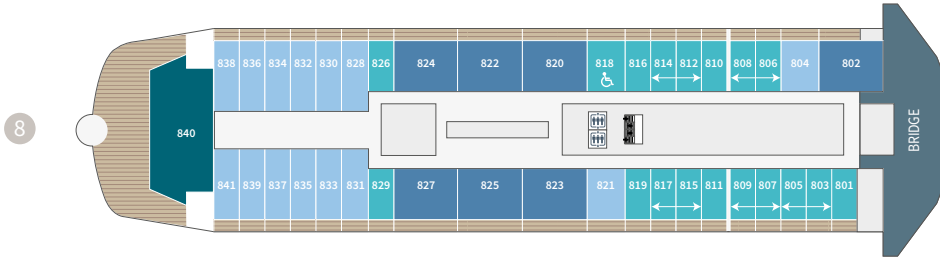
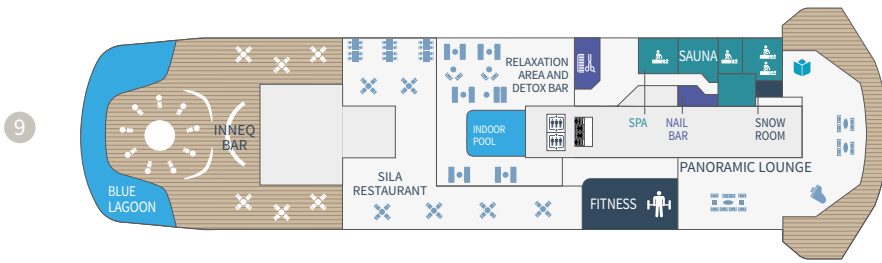

## DECK 5

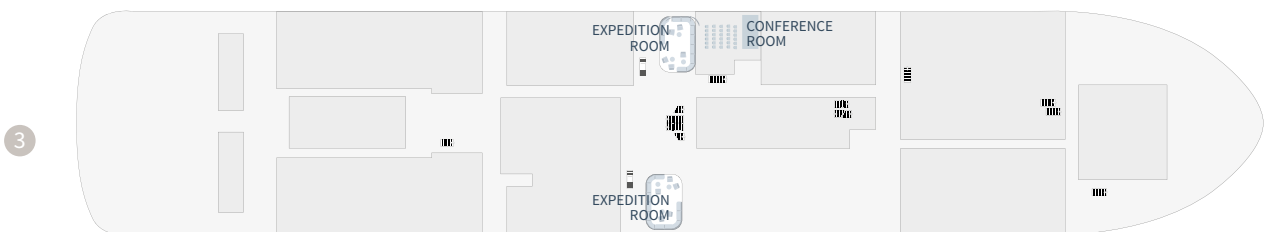
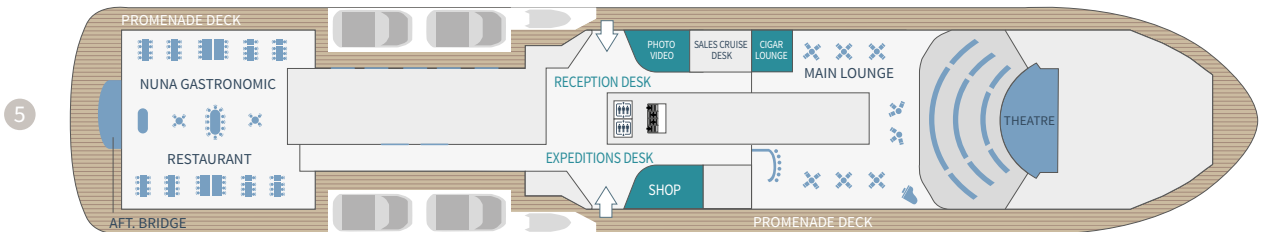



# Discover your stateroom

## OWNER'S SUITE

115 sq.m/1,237 sq.ft + 186 sq.m/2,002 sq.ft private terrace with hot tub - balneo bathtub

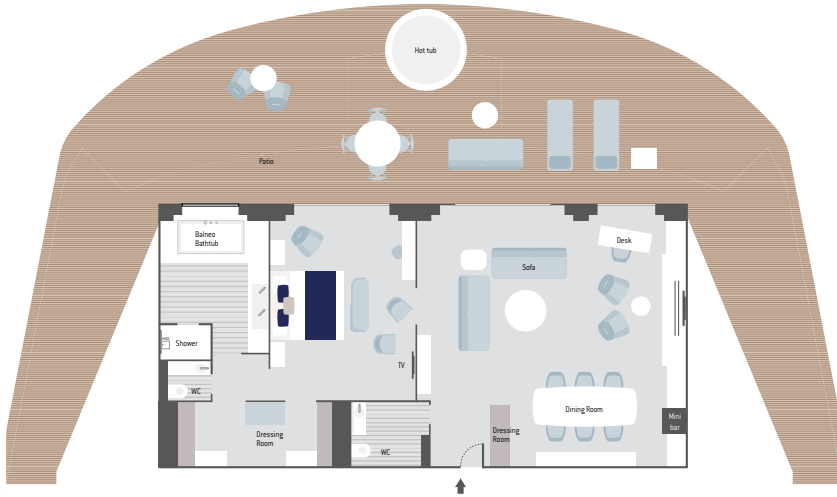

## GRAND PRESTIGE SUITE

42 sq.m/452 sq.ft + 5 sq.m/54 sq.ft private balcony

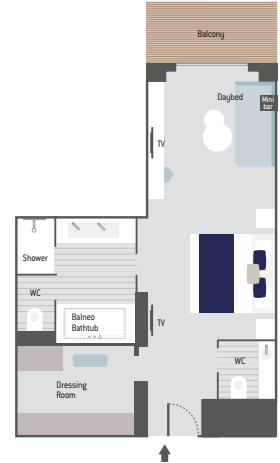

## PRIVILEGE SUITE

48 sq.m/516 sq.ft + 12.5 sq.m/134.5 sq.ft private balcony - balneo bathtub



## PRESTIGE SUITE

40 sq.m/430 sq.ft + 10 sq.m/107 sq.ft private balcony

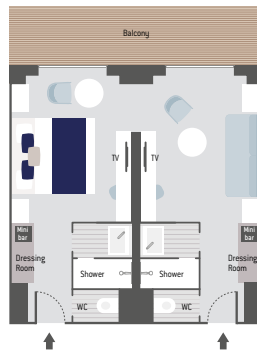

## DUPLEX SUITE

94 sq.m/1,011 sq.ft + 26 sq.m/279 sq.ft private terrace with hot tub - balneo bathtub



## DELUXE SUITE

28 sq.m/301 sq.ft + 5 sq.m/53 sq.ft private balcony



## PRESTIGE STATEROOM

20 sq.m/215 sq.ft + 5 sq.m/53 sq.ft private balcony



## 360° TOUR

Imagine yourself aboard by exploring the suites and staterooms on *Le Commandant Charcot*.



# The PONANT experience rewarded



## Best Premium Cruise Line

Prize awarded at the *Wave Awards 2023*

## Sustainable Initiative of the Year

awarded by luxury travel magazine *Aspire*  
at the *Aspire Awards 2022*

## Pros in the Maritime Category

Prize awarded by *TourMag* magazine  
at the '*Césars du Voyage Responsable*' awards 2023

## The Arctic aboard *Le Commandant Charcot*

one of the 50 World's Greatest Places  
according to *TIME* magazine in 2022

See the full list of our awards at [www.ponant.com](http://www.ponant.com).

## The Life of a Brochure

Did you know that paper can be recycled up to seven times?  
To reduce the environmental impact of our brochures, envelopes and letters,  
we have adopted good practices to ensure a more responsible  
approach all the way to your letterboxes.  
For you too can sort them for recycling to prolong their life cycle.

- ✓ Recycled paper used wherever possible
- ✓ Plastic film wrap replaced by paper or recyclable envelopes
- ✓ Distribution of media materials optimised to more closely meet your needs
- ✓ Obsolete media sent to a processing centre to be sorted and reused



*Juvenile stag on the banks of the St Lawrence River, Canada.*

---

## CONTACT AND RESERVATIONS

Contact our dedicated team:

+33 (0)4 91 26 62 20

[conciergerievoyage@ponant.com](mailto:conciergerievoyage@ponant.com)

---

 Instagram: @ponant  
[@lecommandantcharcot](https://www.instagram.com/lecommandantcharcot)

 Youtube:  
PONANT Cruises

 [facebook.com/ponant](https://www.facebook.com/ponant)  
[facebook.com/LeCommandantCharcot](https://www.facebook.com/LeCommandantCharcot)

Download the PONANT application



PRINTED IN FRANCE



408 avenue du Prado, 13008 Marseille, France | Licence 013060005  
[www.ponant.com](http://www.ponant.com)

TAP-LCC-W24-25-AT-0224 (1) Offer per passenger for any service before or after your cruise booked through PONANT (flights & hotel nights), valid from 5 February to 20 March 2024. Offer non-retroactive and subject to availability and does not apply to the Single Supplement offer or any other specific offer. (2) Price per person based on double occupancy. The price displayed on each product corresponds to the best price available at the time of printing the brochure in January 2024. This price may change as the departure date approaches and varies depending on availability on the cruise. It may change without notice. (3) Flights selected by PONANT in Economy Class. Prices may change depending on availability and the real-time prices charged by airlines. (4) Double stateroom supplement for one person to use offered on selected cruises, the number is limited and dependent on stateroom category. All cruises concerned can be found on our website. Itineraries, activities, wildlife and highlights, as well as the photos used in this brochure represent possible experiences and are not guaranteed. Photos compliant with operational regulations and may be taken during reconnaissance flights. Documents and photos non-contractual. More information in the Terms & Conditions of Sale section at [www.ponant.com/hyperlink-sht-tp://www.ponant.com/stock-reporter](https://www.ponant.com/hyperlink-sht-tp://www.ponant.com/stock-reporter). Photo credits: @Studio PONANT: Ophélie Bleunven - Clément Louineau - Morgane Lanco - Olivier Blaud - Nathalie Michel / @PONANT: Violette Vauchelle - Mike Louagie - Julien Fabro - Gilles Trillard - Ian Dawson / iStock: Ondrej Prosky - Bublik Polina - GC-Shutter - Franck Reporter - Gaia Moments - Maria Vonotna - Michel Mond - Bruev - Scanrail - Blitsky Evgeniy / Adobe Stock: Rob / Production: Claire Bulles, January 2024.